

Rail mounting, 35/45/55 mm

Quick mounting on DIN rail according to DIN 46277/3 (European Norm EN 50022).

Connection terminals shielded to prevent human contact, max. cable 4 mm², protection class IP 20.

Designation and arrangement according to DIN 46 199.

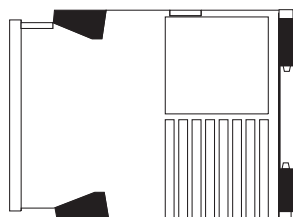

11-pin socket mounting, 35/45/55 mm

Mounting and connection by 11-pin socket with either screw terminals or soldering connections.

Fixation by Retaining Clip BU 351 for 35/45/55 mm

Plug connection according to IEC 67 - 1 - 18a.

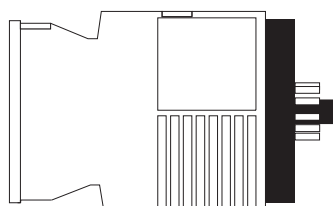

Dimensions:

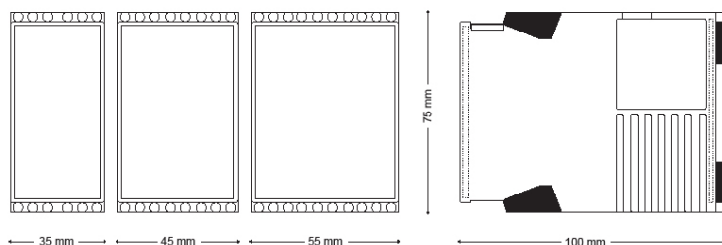

Classification:

VDE 0435
VDE 0110

EN60255

Self - quenching plastic case,
protection class IP 40.

Mounting plate MP 225.
(only 35 mm. housing)

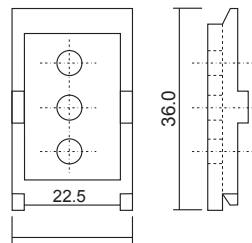

Socket ZKR 118 (11-pin)

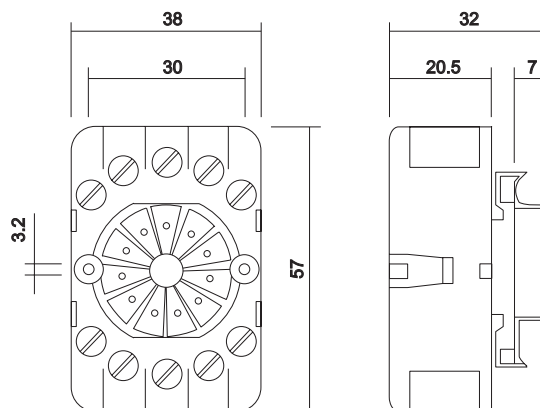

Holding device BU 351

